



Webbs

Helping people move since 1994

**Bakers Way | Hednesford, Cannock | WS12 4XZ**

**Offers Over £230,000**

 **Webbs**  
estate agents



## Summary

**\*\* NO CHAIN \*\* POPULAR LOCATION \*\* INTERNAL VIEWING IS ESSENTIAL \*\* DETACHED FAMILY HOME \*\* THREE/FOUR BEDROOMS \*\* BATHROOM & ENSUITE \*\* MODERN KITCHEN \*\* DINING ROOM \*\* SPACIOUS LOUNGE \*\* BEDROOM FOUR / SITTING ROOM \*\* GUEST WC \*\* CONSERVATORY \*\* PRIVATE REAR GARDEN \*\* PRIVATE DRIVEWAY \*\* UPVC DOUBLE GLAZED \*\* GAS CENTRAL HEATING \*\***

Webbs Estate Agents have pleasure in offering this well-presented detached family home, situated in a popular location, being close to all local amenities, schools, and Hednesford Town Centre & Train Station. Briefly comprises: through the hallway, guest WC, modern kitchen, dining room, lounge, conservatory, bedroom four / sitting room. On the first floor, there is a landing leading to three bedrooms, a family bathroom, and having ensuite to the master bedroom. Externally there is a private driveway and rear garden.

## Key Features

- DETACHED FAMILY HOME
- INTERNAL VIEWING ADVISED
- THREE / FOUR BEDROOMS
- LOUNGE, DINING ROOM
- DRIVEWAY & GARDENS
- POPULAR LOCATION
- NO CHAIN
- BATHROOM & ENSUITE
- KITCHEN, CONSERVATORY

## Rooms and Dimensions

**AWAITING VENDOR APPROVAL**

**THROUGH HALLWAY**

**GUEST WC**

**MODERN KITCHEN**

**DINING ROOM**

**LOUNGE**

**CONSERVATORY**

**SITTING ROOM / BEDROOM FOUR**

**LANDING**

**BEDROOM ONE**

**ENSUITE**

**BEDROOM TWO**

**BEDROOM THREE**

**FAMILY BATHROOM**

**FRONT & REAR GARDENS**

**PRIVATE DRIVEWAY**







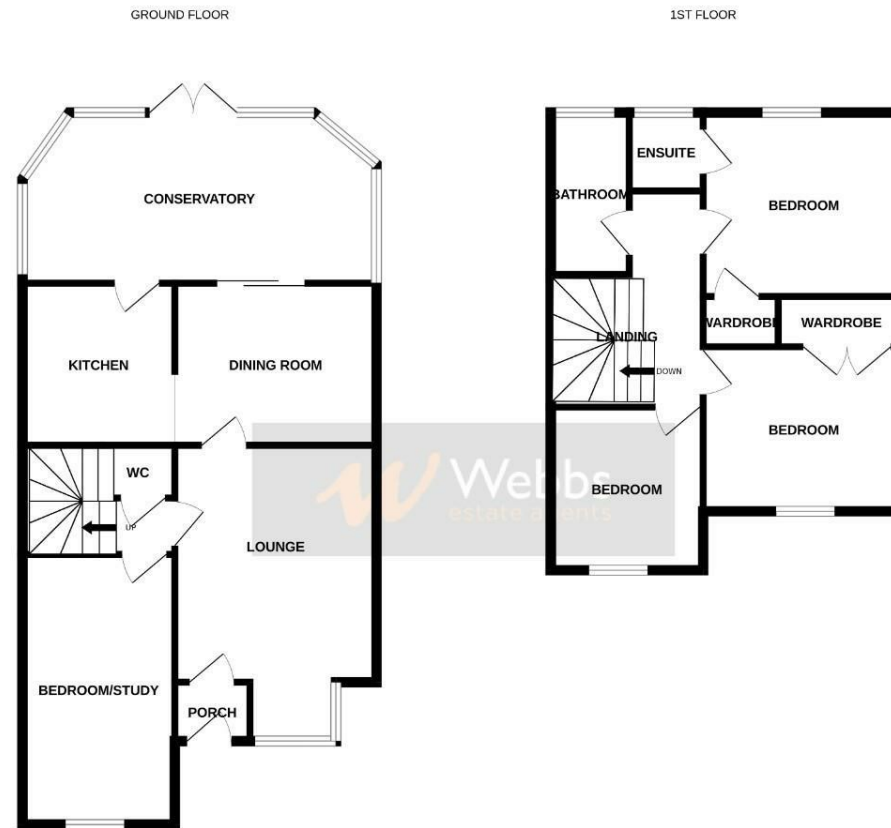

Whilst every attempt has been made to ensure the accuracy of the floorplan contained here, measurements of doors, windows, rooms and any other items are approximate and no responsibility is taken for any error, omission or mis-statement. This plan is for illustrative purposes only and should be used as such by any prospective purchaser. The services, systems and appliances shown have not been tested and no guarantee as to their operability or efficiency can be given.  
Made with Metropix ©2024

Webbs Estate Agents - endeavour to maintain accurate depictions of properties in Virtual Tours, Floor Plans and descriptions, however, these are intended only as a guide and purchasers must satisfy themselves by personal inspection.

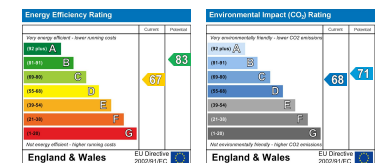

153 Avon Road, Cannock, WS11 1LF

Tel: 01543 468846 | Email: [sales@webbestateagents.co.uk](mailto:sales@webbestateagents.co.uk) | [www.webbestateagents.co.uk](http://www.webbestateagents.co.uk)

**Webbs**  
estate agents